

STATE OF LOUISIANA
OFFICE OF COASTAL PROTECTION & RESTORATION
RESTORATION DIVISION

RIVERINE SAND MINING / SCOFIELD ISLAND RESTORATION
STATE PROJECT NO. BA-40
PLAQUEMINES PARISH, LOUISIANA
PERMIT (MVN2008-3033-EFF)

INDEX TO SHEETS

SHEET NO.	DESCRIPTION
1	TITLE SHEET
2	PROJECT LAYOUT
3-4	ALIGNMENT TABLES AND GENERAL NOTES
5	BORROW AREA MR-B-09 PLAN VIEW
6-7	BORROW AREA MR-B-09 DESIGN SECTIONS
8	BORROW AREA MR-E-09 PLAN VIEW
9-10	BORROW AREA MR-E-09 DESIGN SECTIONS
11	OFFSHORE BORROW AREA PLAN VIEW
12-13	OFFSHORE BORROW AREA DESIGN SECTIONS
14-18	CONVEYANCE CORRIDOR LAYOUT
19	CONVEYANCE CORRIDOR TYPICAL CROSS SECTIONS
20	SCOFIELD OFFSHORE BORROW AREA TRANSPORT CORRIDOR
21	ISLAND RESTORATION PLAN VIEW
22-23	ISLAND RESTORATION DESIGN SECTIONS
24	FLOTATION CHANNEL GULF APPROACH PLAN VIEW & DESIGN SECTIONS
25	MISSISSIPPI RIVER LEVEE CROSSING PLAN VIEW
26	MISSISSIPPI RIVER LEVEE CROSSING SECTIONS
27	HIGHWAY 11 CROSSING DETAIL
28	EMPIRE HARBOR CANAL CROSSING DETAIL
29	BANK STABILIZATION TYPICAL DETAIL
30	HIGHWAY 23 CROSSING DETAIL
31	CASING PIPE CAP & CROSSING MARKER DETAIL
32	HURRICANE PROTECTION LEVEE CROSSING PLAN VIEW
33	HURRICANE PROTECTION LEVEE CROSSING SECTIONS
34	EMPIRE MARSH & ROCK REVETMENT CROSSING DETAIL
35	EMPIRE WATERWAY NAVIGATIONAL CROSSING TYPICAL DETAIL
36	BOOSTER PUMP SITE TYPICAL DETAIL
37	NAVIGATION AND SHOAL SIGN DETAIL
38	SAND FENCING DETAIL

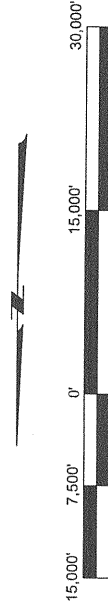
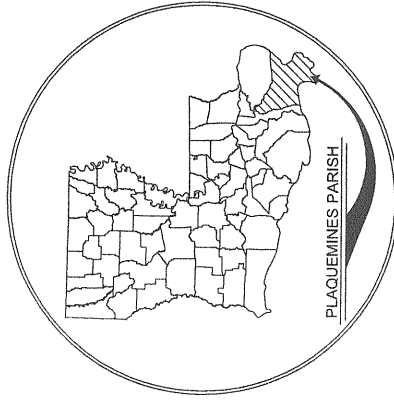
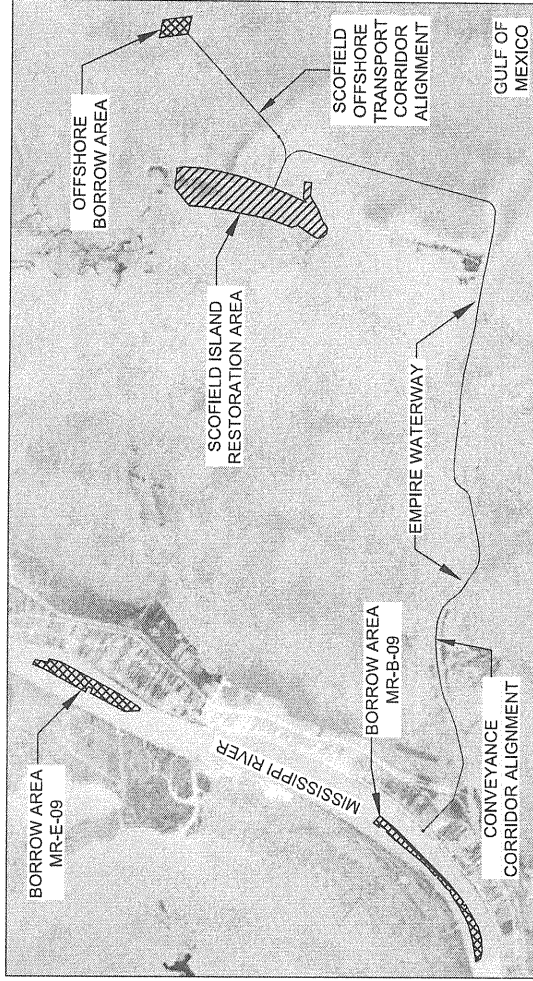

THIS DRAWING SET IS FOR PERMITTING PURPOSES ONLY AND NOT TO BE USED FOR CONSTRUCTION.

BY MTP	DESCRIPTION	DATE	RIVERINE SAND MINING / SCOFIELD ISLAND RESTORATION	TITLE SHEET
	COMMENT RESPONSE	02/10 2011		
MTP	LEVEE CROSSINGS: PAGE NUMBERS	05/06 2011	OFFICE OF COASTAL PROTECTION & RESTORATION RESTORATION DIVISION 450 LAUREL STREET BATON ROUGE, LOUISIANA 70801	DATE: NOVEMBER, 2010
DRAWN BY: DARTEZA ZWERNEMAN			APPROVED BY: MAURY CHATELLIER, P.E.	FEDERAL PROJECT NUMBER: BA-40
			DESIGNED BY: MICHAEL T. POFF, P.E.	SHEET 1 OF 38



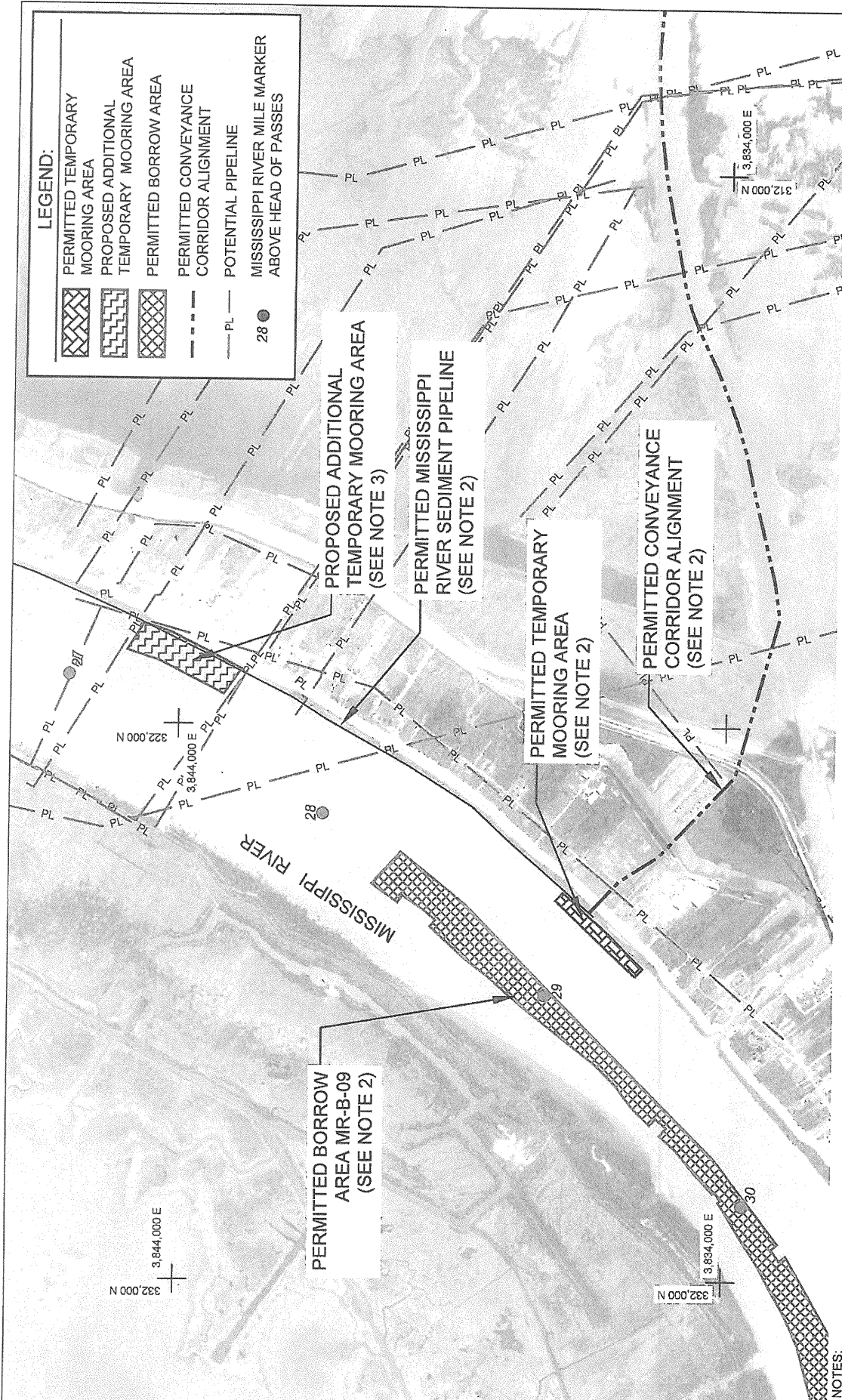

- NOTES:**
1. AERIAL IMAGE FROM U.S. DEPARTMENT OF AGRICULTURE, NOVEMBER 2007.
 2. CURRENTLY PERMITTED UNDER C.U.P. P20101416 AND C.O.E. MVN-2008-03033-ETT.
 3. SEE SHEET 2 OF PERMIT MODIFICATION REQUEST NO.1 FOR ADDITIONAL TEMPORARY MOORING AREA DETAILS.
 4. COORDINATES IN NAD 83, LOUISIANA STATE PLANE, SOUTH ZONE, U.S. SURVEY FT.

BY MTP	DESCRIPTION CWD/SURFACE PERMIT MODIFICATION REQUEST 1	DATE 08/23 2012	OFFICE OF COASTAL PROTECTION & RESTORATION RESTORATION DIVISION 480 LAUREL STREET BATON ROUGE, LOUISIANA 70801	RIVERINE SAND MINING / SCOFFIELD ISLAND RESTORATION	ADDITIONAL TEMPORARY MOORING AREA OVERVIEW
	DRAWN BY: STEVE DARTEZ				
DESIGNED BY: MICHAEL T. POFF, P.E.			FEDERAL PROJECT NUMBER: BA-40		
APPROVED BY: BARRY RICHARD, P.E.			SHEET 1 OF 5		

ADDITIONAL TEMPORARY MOORING AREA	COORD. PT	NORTHING	EASTING
1	321.462	3,843,179	
2	320.865	3,844,371	
3	320.684	3,844,945	
4	320.203	3,844,643	
5	320.353	3,844,164	
6	321.009	3,842,855	

LEGEND:

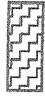
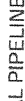
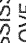
-  PROPOSED ADDITIONAL TEMPORARY MOORING AREA
-  POTENTIAL PIPELINE
-  MISSISSIPPI RIVER MILE MARKER ABOVE HEAD OF PASSES

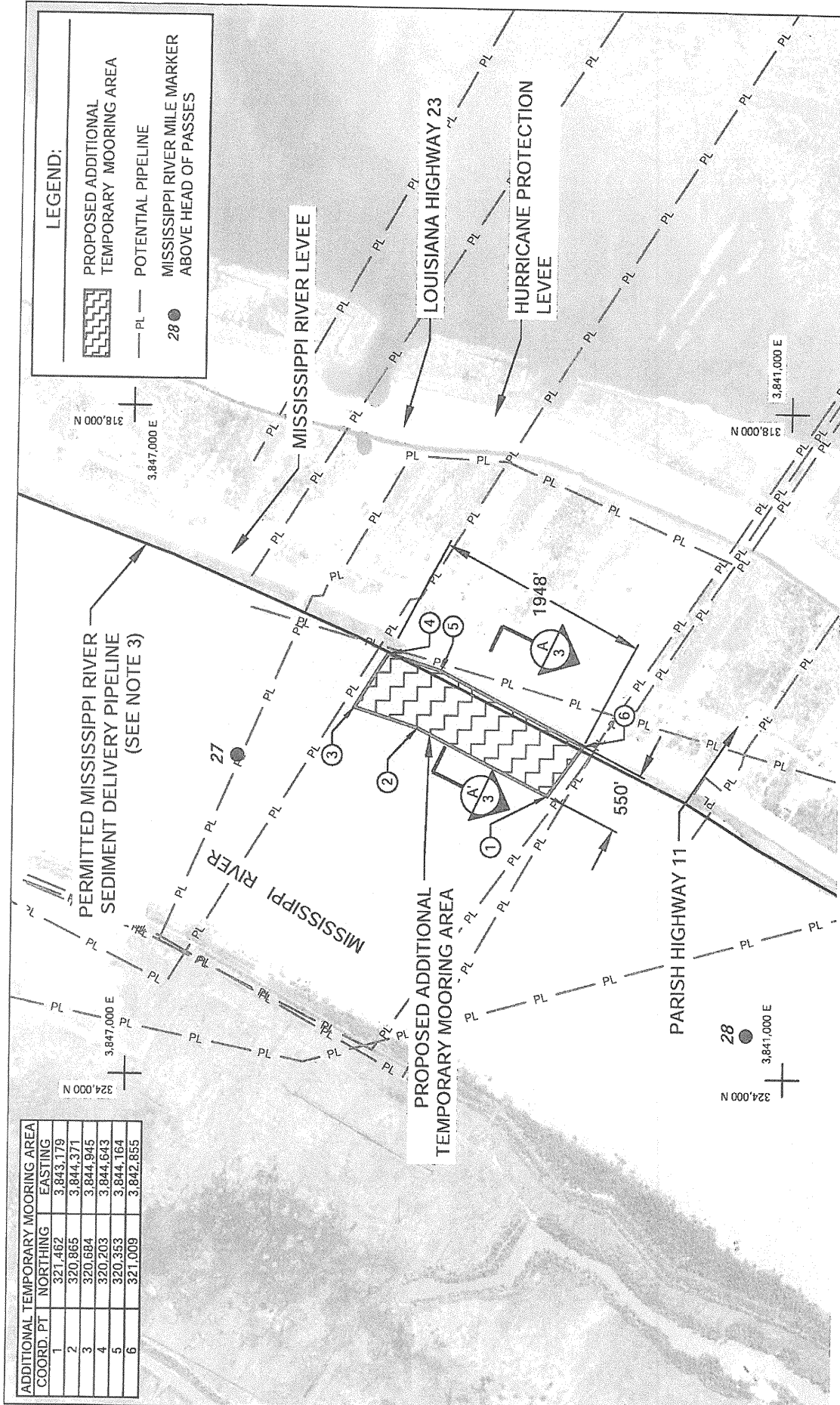

NOTES:
 1. AERIAL IMAGE FROM U.S. DEPARTMENT OF AGRICULTURE, NOVEMBER 2007.
 2. COORDINATES IN NAD 83, LOUISIANA STATE PLANE, SOUTH ZONE, U.S. SURVEY FT.
 3. CURRENTLY PERMITTED UNDER C.U.P. P20101416 AND C.O.E. MVN-2008-03033-ETT.

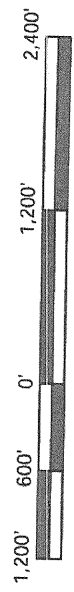

BY	DESCRIPTION	DATE
MTP	CMD/USACE PERMIT MODIFICATION REQUEST 1	08/23 2012

COASTAL ENGINEERING CONSULTANTS, INC

OFFICE OF COASTAL PROTECTION & RESTORATION
 RESTORATION DIVISION
 450 LAUREL STREET
 BATON ROUGE, LOUISIANA 70801

RIVERINE SAND MINING / SCOFIELD ISLAND RESTORATION
 PLAN VIEW

STATE PROJECT NUMBER: BA-40
 FEDERAL PROJECT NUMBER: BA-40

DATE: AUGUST, 2012
 SHEET 2 OF 5

DRAWN BY: STEVE DARTZ

DESIGNED BY: MICHAEL T. POFF, P.E.

APPROVED BY: BARRY RICHARD, P.E.

SCALE:
 H: 1" = 200'
 V: 1" = 20'

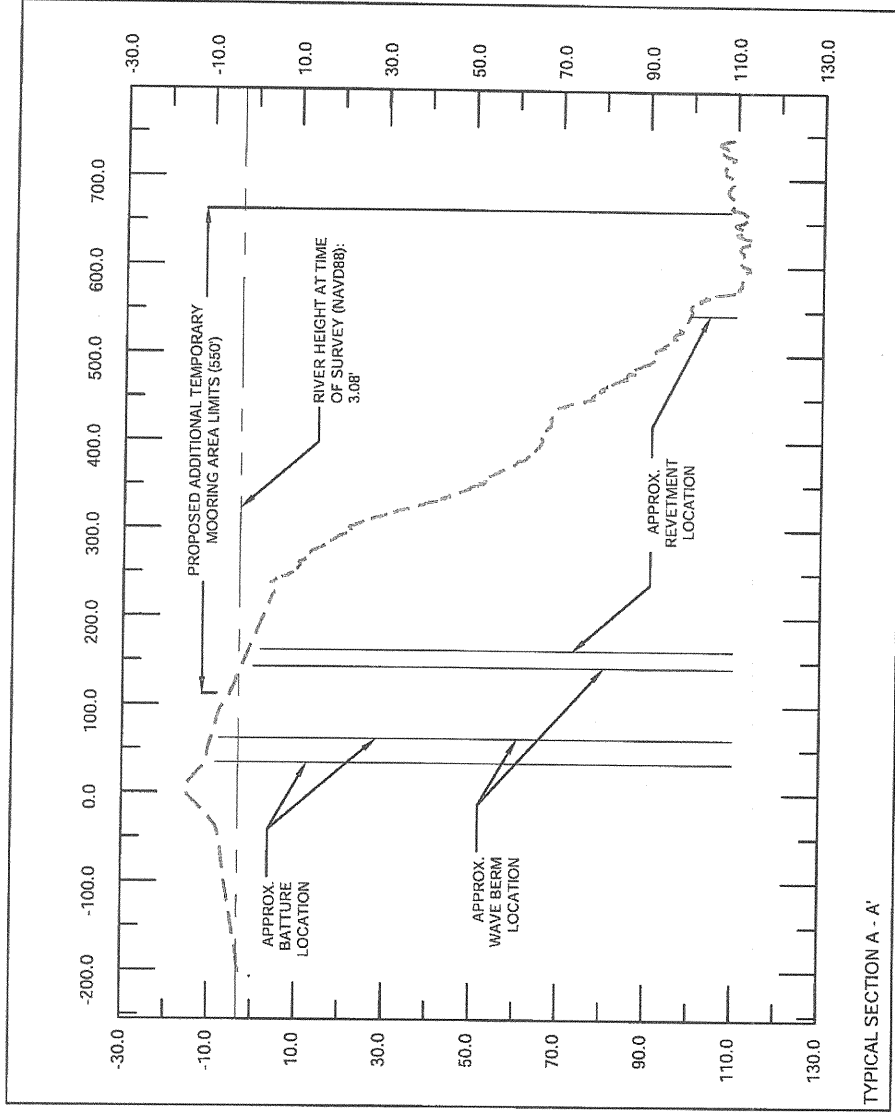

TYPICAL SECTION A - A'

- NOTES:
1. ELEVATIONS ARE NORTH AMERICAN VERTICAL DATUM 1988 (NAVD88), U.S. SURVEY FT.
 2. SURVEY PERFORMED BY GREAT LAKES DREDGE AND DOCK COMPANY, JUNE 2012.
 3. ANCHORS FOR BOOSTER PUMP STATIONED IN THE PROPOSED ADDITIONAL TEMPORARY MOORING AREA SHALL BE PLACED ON THE WAVE BERM AREA AND BELOW THE REVETMENT PER COORDINATION WITH U.S. ARMY CORPS OF ENGINEERS, OPERATIONS AND PERMITTING DEPARTMENTS, JUNE 6, 2012..
 4. ANCHOR LOCATIONS SHALL BE MARKED WITH ANCHOR BUOYS THAT CONFORM TO U.S. COAST GUARD REQUIREMENTS.

BY	DESCRIPTION	DATE
MTP	CM/DUSACE PERMIT MODIFICATION REQUEST 1	08/23 2012

DESIGNED BY: MICHAEL T. POFF, P.E.

OFFICE OF COASTAL PROTECTION & RESTORATION
 RESTORATION DIVISION
 450 LAUREL STREET
 BATON ROUGE, LOUISIANA 70801

APPROVED BY: BARRY RICHARD, P.E.

RIVERINE SAND MINING / SCOFIELD ISLAND RESTORATION

ADDITIONAL TEMPORARY MOORING AREA TYPICAL SECTION

STATE PROJECT NUMBER: BA-40

FEDERAL PROJECT NUMBER: BA-40

DATE: AUGUST, 2012

SHEET 3 OF 5

LEGEND:

	PERMITTED CONVEYANCE CORRIDOR
	APPROX. EMPIRE WATERWAY CHANNEL
	EMPIRE WATERWAY APPROX. RW

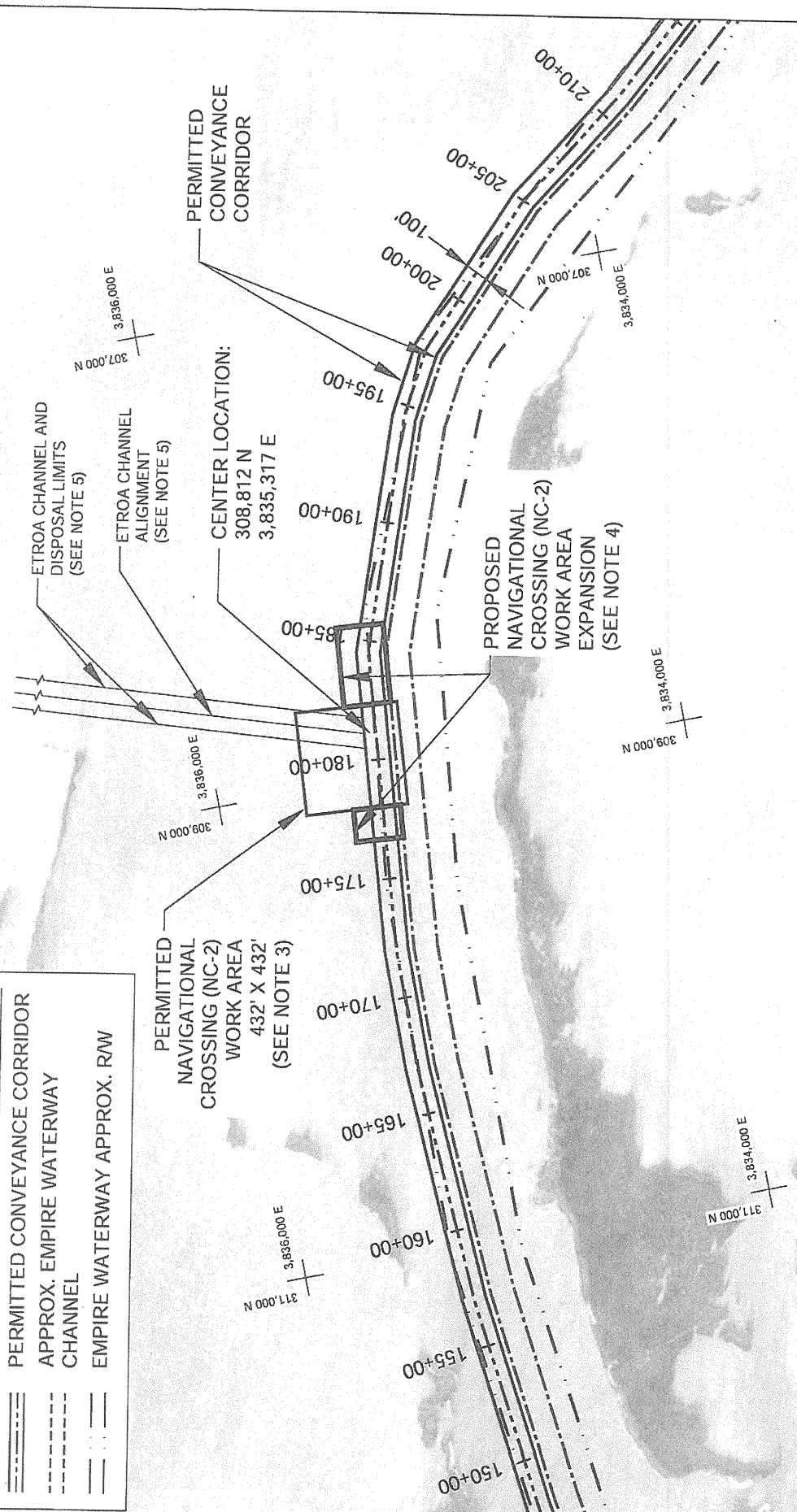

- NOTES:**
1. AERIAL IMAGE FROM U.S. DEPARTMENT OF AGRICULTURE, NOVEMBER 2007.
 2. COORDINATES IN NAD 83, LOUISIANA STATE PLANE, SOUTH ZONE, U.S. SURVEY FT.
 3. CURRENTLY PERMITTED UNDER C.U.P. P20101416 AND C.O.E. MVN-2008-03033-ETT.
 4. NO ADDITIONAL IMPACTS TO NON-VEGETATED WATERBOTTOMS OTHER THAN THOSE PREVIOUSLY PERMITTED. EXPANDED WORK AREA TO BE UTILIZED FOR FIELD FITTING OF CROSSING FOR ETROA PLANNED CHANNEL EXCAVATION UNDER ETROA'S OWN PERMIT.
 5. ETROA RESOURCES, LLC. C.U.P. PERMIT APPLICATION NUMBER P2011584.

BY	DESCRIPTION	DATE	COASTAL ENGINEERING CONSULTANTS, INC OFFICE OF COASTAL PROTECTION & RESTORATION RESTORATION DIVISION 450 LAUREL STREET BATON ROUGE, LOUISIANA 70801	RIVERINE SAND MINING / SCOFIELD ISLAND RESTORATION	NAVIGATIONAL CROSSING NO. 2 WORK AREA EXPANSION
MTP	CMD/USAGE PERMIT MODIFICATION REQUEST 1	08/23 2012			
DRAWN BY: STEVE DARTEZ			DATE: AUGUST, 2012		
DESIGNED BY: MICHAEL T. POFF, P.E.			STATE PROJECT NUMBER: BA-40		
APPROVED BY: BARRY RICHARD, P.E.			FEDERAL PROJECT NUMBER: BA-40		
SHEET 4 OF 5					

LEGEND:

	PERMITTED CONVEYANCE CORRIDOR
	APPROX. EMPIRE WATERWAY CHANNEL
	EMPIRE WATERWAY APPROX. R/W

PROPOSED NAVIGATIONAL CROSSING (NC-6) WORK AREA EXPANSION (SEE NOTE 4)

PERMITTED NAVIGATIONAL CROSSING (NC-6) WORK AREA 400' X 400' (SEE NOTE 3)

PERMITTED CONVEYANCE CORRIDOR

EMPIRE WATERWAY JETTIES

CENTER LOCATION:
280,323 N
3,831,691 E

- NOTES:**
- AERIAL IMAGE FROM U.S. DEPARTMENT OF AGRICULTURE, NOVEMBER 2007.
 - COORDINATES IN NAD 83, LOUISIANA STATE PLANE, SOUTH ZONE, U.S. SURVEY FT.
 - CURRENTLY PERMITTED UNDER C.U.P. P20101416 AND C.O.E. MVN-2008-03033-ETT.
 - NO ADDITIONAL IMPACTS TO NON-VEGETATED WATERBOTTOMS OTHER THAN THOSE PREVIOUSLY PERMITTED. EXPANDED WORK AREA TO BE UTILIZED FOR FIELD FITTING OF CROSSING.

BY	DESCRIPTION	DATE
MTP	CMD/USACE PERMIT MODIFICATION REQUEST 1	08/23 2012



DESIGNED BY: MICHAEL T. POFF, P.E.

APPROVED BY: BARRY RICHARD, P.E.

OFFICE OF COASTAL PROTECTION & RESTORATION
RESTORATION DIVISION
450 LAUREL STREET
BATON ROUGE, LOUISIANA 70801

RIVERINE SAND MINING / SCOFIELD ISLAND RESTORATION

STATE PROJECT NUMBER: BA-40

FEDERAL PROJECT NUMBER: BA-40

NAVIGATIONAL CROSSING NO. 6 WORK AREA EXPANSION

DATE: AUGUST, 2012

SHEET 5 OF 5

